

TECHNICAL SHEET

# ELBOW BLIND 40°

W.15-WKT

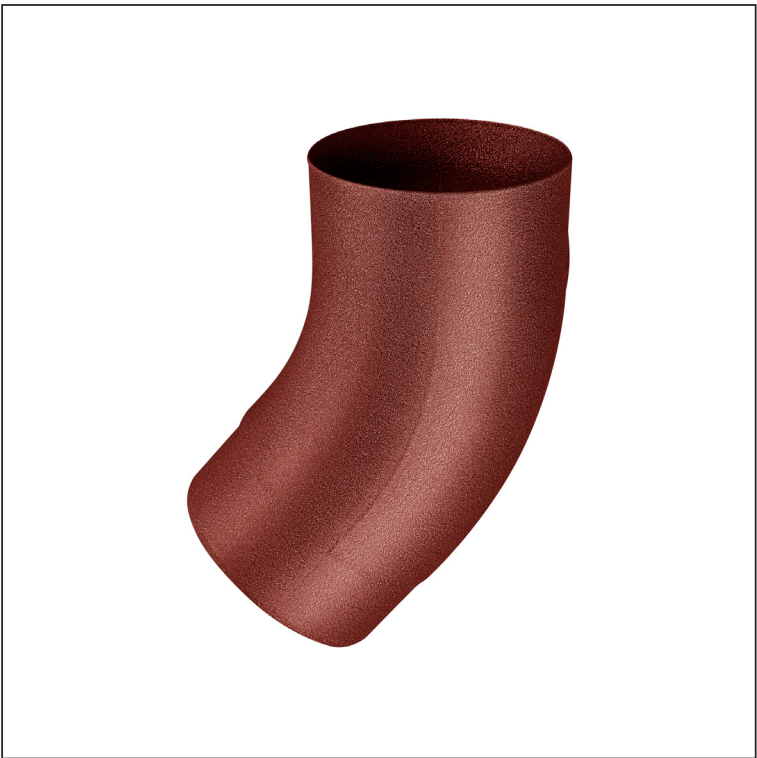
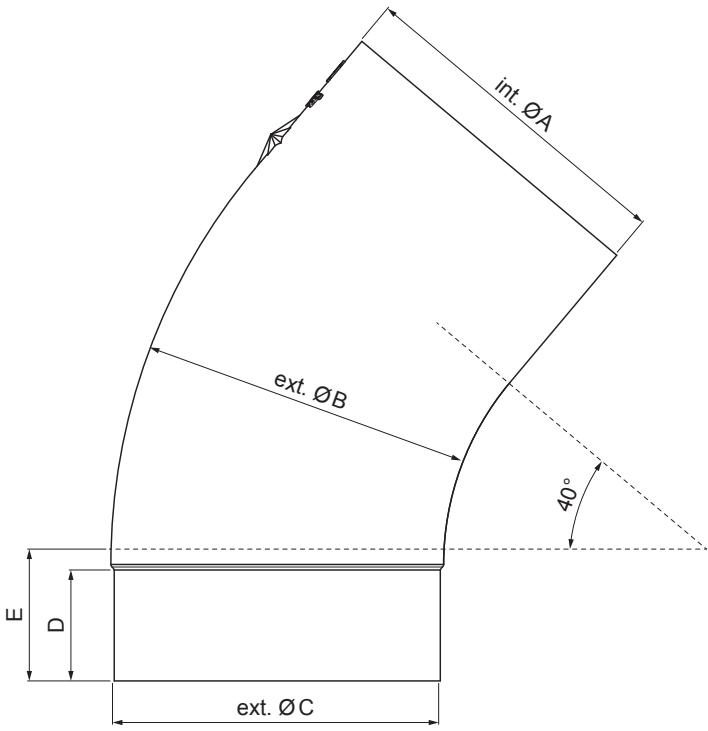

**OCM** Aluminium preprinted W.15 – Steel red W.15 – RAL 3009

Dimensions [mm]					
Nominal size	Ø A	Ø B	Ø C	D	E
80	80,4	79	76,9	28	40
100	100,4	99,0	96,8	35	50
120	120,3	119,0	116,7	42	60

INDEX	CHANGE	DATE	SIGNATURE	<b>KJG</b> QUALITY ®	
MATERIAL BRAND			W.C.	WEIGHT kg	SCALE
SIZE, SEMI-FINISHED PRODUCTS				STN STANDARD	SORTING NUMBER
AUXILIARY EQUIPMENT				NOTE	POSITION NUMBER
ELABORATED BY Ing. Kluska M.					
TESTED BY					
TECHNOLOGIST		TECHNOLOGIST		OLD DRAWING	DRAWING NUMBER
NAME			W.15-WKT		
Elbow blind 40°			Number of sheets		