

TECHNICAL SHEET

OUTLET SQUARE

PH-PKLH

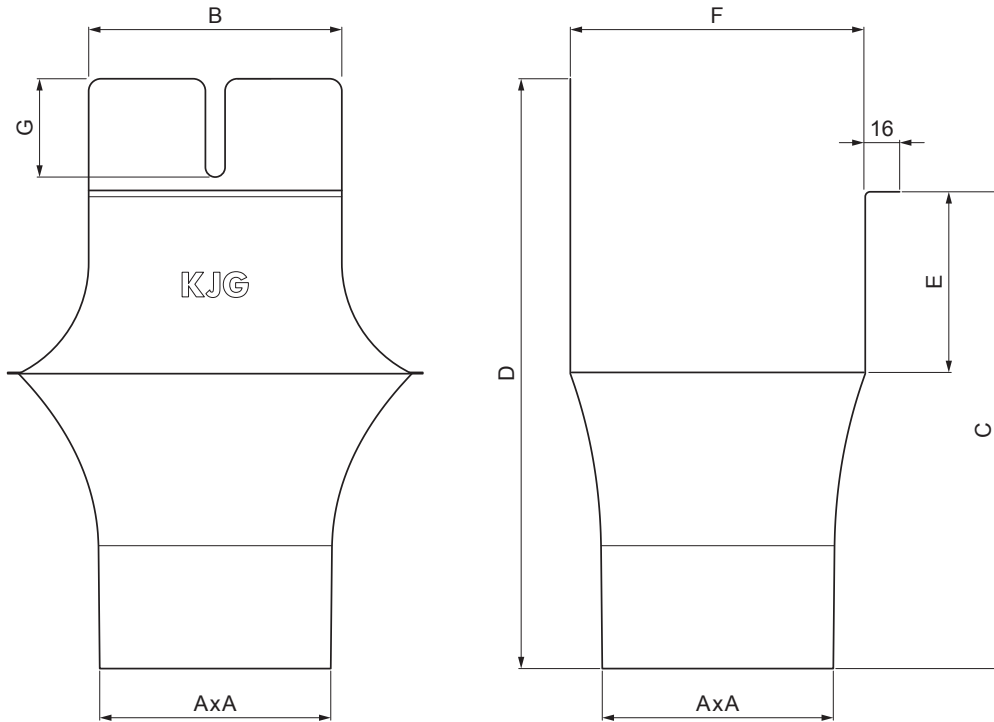

MM Galvanized steel prepainted – Metallic copper – RAL extra

| Dimensions [mm] | | | | | | | |
|-----------------|---------|-----|-----|-----|----|-----|----|
| Nominal size | AxA | B | C | D | E | F | G |
| 250-80/80 | 80x80 | 80 | 138 | 180 | 41 | 85 | 50 |
| 333-80/80 | 80x80 | 103 | 176 | 240 | 58 | 120 | 40 |
| 333-100/100 | 100x100 | 103 | 176 | 240 | 58 | 120 | 40 |
| 400-100/100 | 100x100 | 113 | 207 | 272 | 73 | 150 | 57 |
| 400-120/120 | 120x120 | 130 | 207 | 276 | 73 | 150 | 50 |
| 500-150/150 | 150x150 | 165 | 288 | 373 | 93 | 200 | 60 |

| | | | | | | |
|------------------------------|--------|------|---------------|------------------------|------------------------|--|
| INDEX | CHANGE | DATE | SIGNATURE | KJG QUALITY® | Scan code for 3D model | |
| | | | | | | |
| MATERIAL BRAND | | | W.C. | WEIGHT kg | SCALE | |
| SIZE, SEMI-FINISHED PRODUCTS | | | STN STANDARD | | SORTING NUMBER | |
| AUXILIARY EQUIPMENT | | | NOTE | | POSITION NUMBER | |
| ELABORATED BY Ing. Kluska M. | | | OLD DRAWING | | DRAWING NUMBER | |
| TESTED BY | | | NAME | | PH-PKLH | |
| TECHNOLOGIST | | | Outlet square | | Number of sheets | |
| NAME | | | | | Sheet | |

Created: 06.06.2026 15:29:44

Technical changes reserved