

TECHNICAL SHEET

GUTTER HOOK SQUARE

WH-WHH

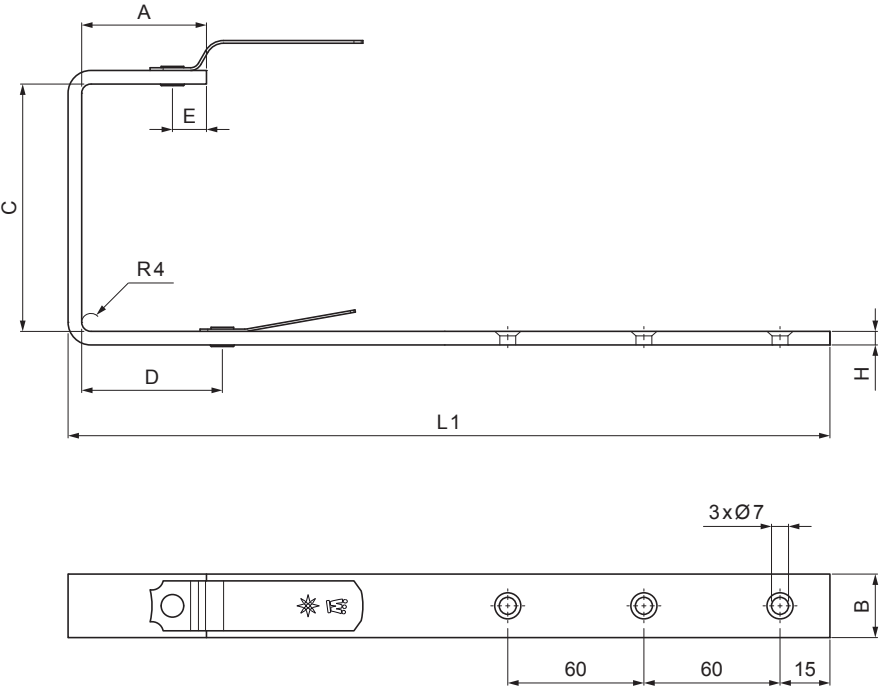

ZS Aluminium preprinted – Zinc grey – RAL extra

| | | | | | | |
|------------------------------|--------|------|--------------------|------------------------|------------------------|--|
| INDEX | CHANGE | DATE | SIGNATURE | KJG QUALITY® | Scan code for 3D model | |
| MATERIAL BRAND | | | W.C. | WEIGHT kg | SCALE | |
| SIZE, SEMI-FINISHED PRODUCTS | | | STN STANDARD | | SORTING NUMBER | |
| AUXILIARY EQUIPMENT | | | NOTE | | POSITION NUMBER | |
| ELABORATED BY Ing. Kluska M. | | | OLD DRAWING | | DRAWING NUMBER | |
| TESTED BY | | | TECHNOLOGIST | | DRAWING NUMBER | |
| NAME | | | Gutter hook square | | Number of sheets | |
| | | | | | WH-WHH | |
| | | | | | Sheet | |

Created: 04.12.2025 10:34:45

Technical changes reserved

| Dimensions [mm] | | | | | | |
|-----------------|----|--------|-----|----|----|-----|
| Nominal size | A | B x H | C | D | E | L 1 |
| 250/430 | 38 | 23 x 7 | 87 | 48 | 15 | 325 |
| 333/550 | 55 | 28 x 7 | 123 | 66 | 15 | 370 |
| 400/650 | 68 | 30 x 7 | 153 | 82 | 15 | 435 |