

TECHNICAL SHEET

TRAPEZOIDAL SHEET ROOF WITH EMBOSSING TR 35A+ TR-35A+

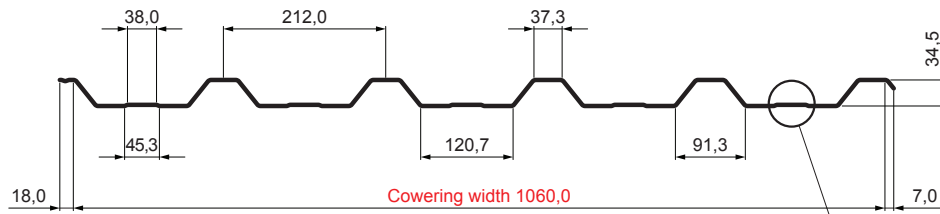

A+ = reinforcement

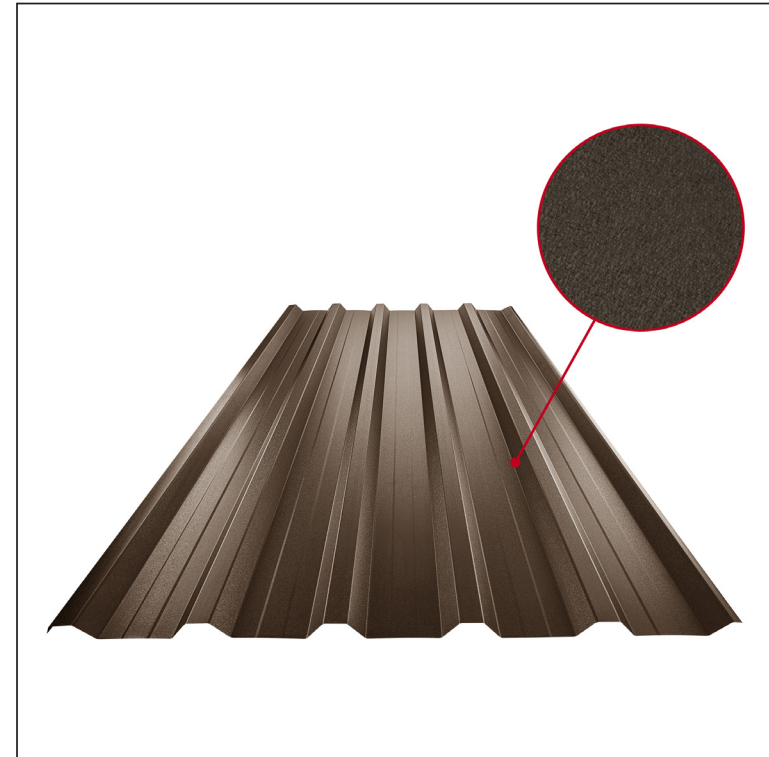
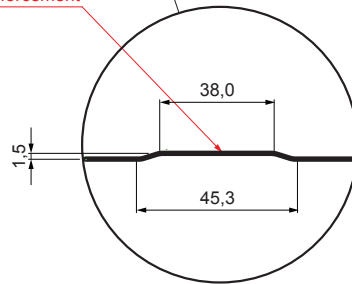

Galvanized steel prepainted MATT – Testa di Moro MATT – RAL 8028

INDEX	CHANGE	DATE	SIGNATURE				
MATERIAL BRAND			W.C.	WEIGHT kg	SCALE		
SIZE, SEMI-FINISHED PRODUCTS			STN STANDARD		SORTING NUMBER		
AUXILIARY EQUIPMENT			NOTE		POSITION NUMBER		
ELABORATED BY Ing. Kluska M.			TECHNOLOGIST		OLD DRAWING		DRAWING NUMBER
TESTED BY			NAME		TR-35A+		
TECHNOLOGIST			Trapezoidal sheet roof with embossing TR 35A+		Number of sheets		Sheet

Created: 20.04.2026 08:22:54

Technical changes reserved

Technical parameters [mm]	
Covering width	1060,0
Total width	1085,0
Profile height	34,5
Metal sheet thickness	0,50
Roof covering length	max. 8000,0