

TECHNICAL SHEET

PLATE WASHER ALUZINC

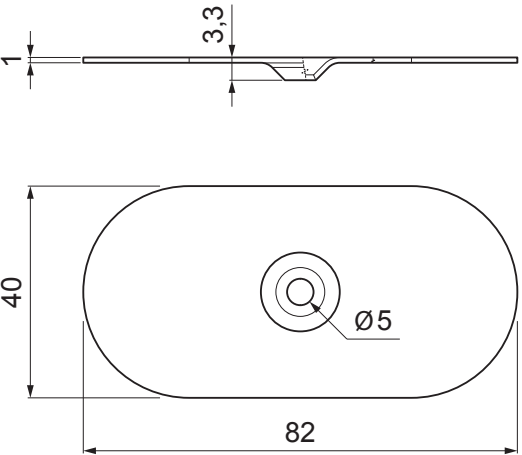

USE:
- for mechanical anchoring the waterproofing to the supporting structure made of trapezoidal steel sheet, wood, and board materials

MATERIAL:
- steel with surface treatment ALUZINC

DETAIL:
1. supporting structure
2. thermal insulation
3. waterproofing
4. plate washer ALUZINC
5. galvanized screw DABO
6. top foil

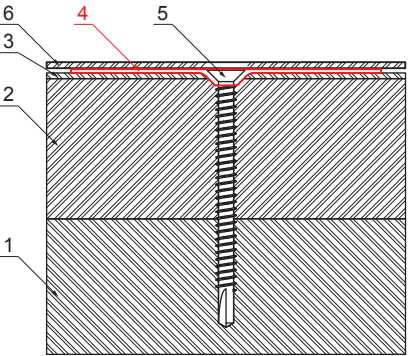

TR-ORK-HTV-TK



AZ ALUZINC

INDEX	CHANGE	DATE	SIGNATURE	KJG QUALITY ®		Scan code for 3D model	QR CODE
MATERIAL BRAND			W.C.	WEIGHT kg	SCALE		
SIZE, SEMI-FINISHED PRODUCTS				STN STANDARD	SORTING NUMBER		
AUXILIARY EQUIPMENT				NOTE	POSITION NUMBER		
ELABORATED BY Ing. Kluska M.				OLD DRAWING	DRAWING NUMBER		
TESTED BY				TECHNOLOGIST	NAME		
Plate washer ALUZINC				Number of sheets	TR-ORK-HTV-TK		
					Sheet		