

TECHNICAL SHEET

SIDE HOPPER

IT-KLZF B

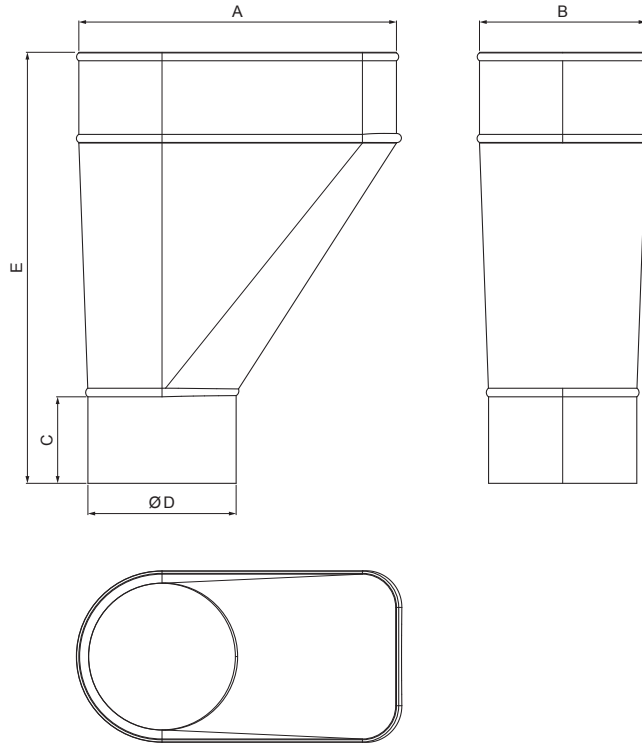

OC Galvanized steel pre-painted – Steel red – RAL 3009

Dimensions [mm]					
Nominal size	A	B	C	ØD	E
60	130	66	55	60	210
80	170	90	55	80	245
100	210	110	55	100	245
120	250	130	55	120	270

INDEX	CHANGE	DATE	SIGNATURE	KJG QUALITY®	Scan code for 3D model
MATERIAL BRAND			W.C.	WEIGHT kg	SCALE
SIZE, SEMI-FINISHED PRODUCTS			STN STANDARD		SORTING NUMBER
AUXILIARY EQUIPMENT			NOTE		POSITION NUMBER
ELABORATED BY Ing. Kluska M.			OLD DRAWING		DRAWING NUMBER
TESTED BY			NAME		
TECHNOLOGIST			Side hopper		Number of sheets
TECHNOLOGIST					IT-KLZF B Sheet

Created: 25.05.2026 15:42:31

Technical changes reserved