

TECHNICAL SHEET

MOUNTING CAP 16/4

SM-KM

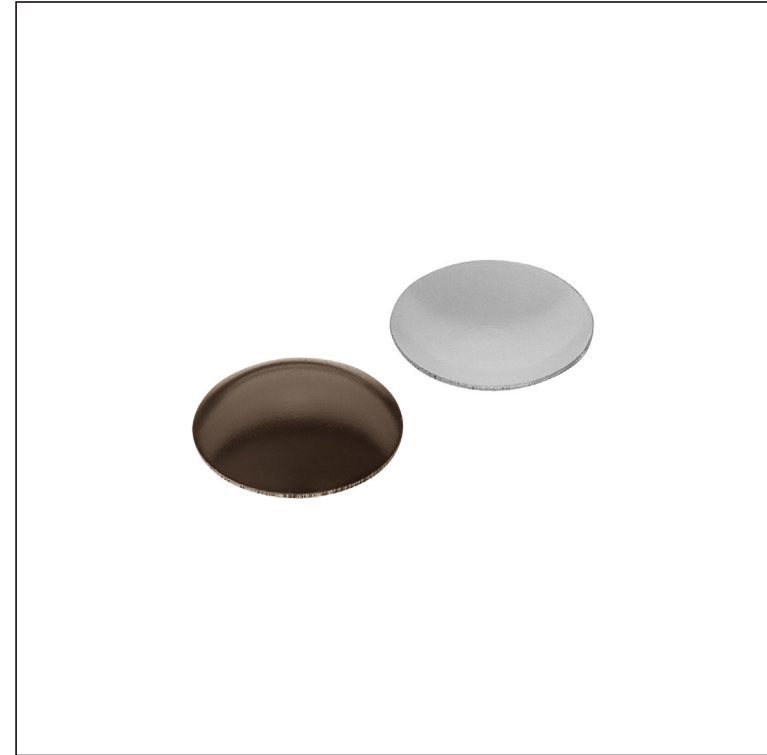
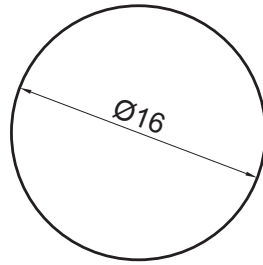

TM Galvanized steel prepainted – Testa di Moro – RAL 8028

INDEX CHANGE		DATE	SIGNATURE	KJG QUALITY®	Scan code for 3D model	
MATERIAL BRAND			W.C.	WEIGHT kg	SCALE	
SIZE, SEMI-FINISHED PRODUCTS			STN STANDARD		SORTING NUMBER	
AUXILIARY EQUIPMENT			NOTE		POSITION NUMBER	
ELABORATED BY Ing. Kluska M.			OLD DRAWING		DRAWING NUMBER	
TESTED BY			TECHNOLOGIST		DRAWING NUMBER	
NAME			Mounting cap 16/4		Number of sheets SM-KM Sheet	

Created: 04.06.2026 23:32:45

Technical changes reserved