

TECHNICAL SHEET

GUTTER HOOK

W-WHP

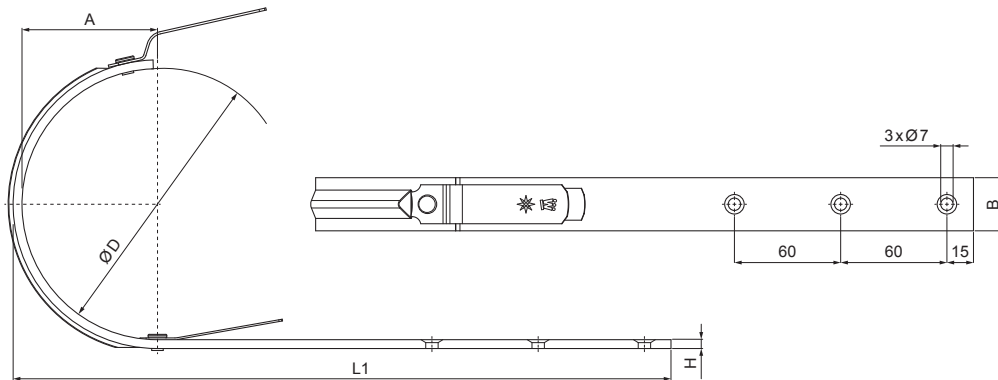

SS Aluminium pre-painted – Mouse grey – RAL 7005

| Dimensions [mm] | | | | |
|-----------------|----|--------|-----|-----|
| Nominal size | A | B x H | ØD | L1 |
| 250/430 | 50 | 23 x 7 | 105 | 310 |
| 280/480 | 61 | 28 x 7 | 127 | 337 |
| 333/550 | 74 | 28 x 7 | 153 | 385 |
| 333/650 | 74 | 28 x 7 | 153 | 485 |
| 400/650 | 93 | 30 x 7 | 192 | 436 |

| | | | | | |
|------------------------------|--------|--------------|-----------|------------------------|------------------------|
| INDEX | CHANGE | DATE | SIGNATURE | KJG QUALITY® | Scan code for 3D model |
| | | | | | |
| MATERIAL BRAND | | | W.C. | WEIGHT kg | SCALE |
| SIZE, SEMI-FINISHED PRODUCTS | | | | STN STANDARD | SORTING NUMBER |
| AUXILIARY EQUIPMENT | | | | NOTE | POSITION NUMBER |
| ELABORATED BY Ing. Kluska M. | | | | | |
| TESTED BY | | | | | |
| TECHNOLOGIST | | TECHNOLOGIST | | OLD DRAWING | DRAWING NUMBER |
| NAME Gutter hook | | | | Number of sheets | W-WHP Sheet |

Created: 20.04.2026 15:44:21

Technical changes reserved